

DABOTEK

Capacitor Discharge STUDS (CD)
Kondensator BOLZEN (CD)
Kondensatorbolte BOLTE (CD)
+ Short Cycle (SC) and other weld nuts



E-mail: DABOTEK
Tilbage til: [Første side](#)

STANDARD CD and SC STUDS					
<p>CD Threaded Stud - P1-2</p>	<p>CD Tap Stud - P3-4</p>	<p>CD Tapped Stud -P5</p>	<p>CD ISO Pin - P6</p>	<p>CD 1mm pin Needles - P7</p>	<p>Spadestik - P8</p>
<p>Short Circle Threaded Stud P9-10</p>	<p>SC Tap Stud P11-12</p>	<p>SC Tapped Stud P13</p>	<p>More technical details: Technical Information. p26</p>		<p>See also our pages with applications: Applications of Stud welding P28</p>
SPECIAL CD and SC STUDS - SONDER CD and SC BOLZEN					
<p>SC Shortcycle P14</p>	<p>CD Xmas Stud P15</p>	<p>CD Tapped Stud 16</p>	<p>CD Tapped no flange p17</p>	<p>CD UNC Threaded Stud - P18</p>	<p>CD UNF Threaded Stud - P19</p>
<p>CD ALU/ Stainles ISO Pin P20</p>	<p>CD Collar Stud P21</p>	<p>CD Shoulder Stud P22</p>	<p>BW Weld Bolts P23</p>	<p>BW Weld Bolts P24</p>	<p>BW Weld Nuts P25</p>

All DABOTEK studs are low carbon St37-3 K mild steel according to DIN32500 and DIN 32501.

Our Capacitor Discharge Stud program starts from 1 mm to 10 mm.

Upon request, the following types of surface protection can be supplied: a) zink plating b) zinc die-chromating c) copper plating d) nickel plating e) Cadmium Plating f) sheradizing

DABOTEK Trading ApS
Birkedam 10C - DK 6000 Kolding
Tel: + 45 75 505 666 - Fax:+ 45 75 504 795

MORE INFORMATION :
E-mail: SALES@DABOTEK.COM

DABOTEK STUD SPECIFICATION

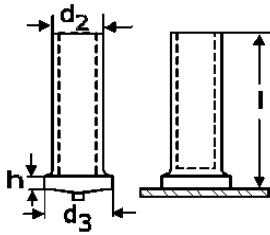

CD Gewindebolzen
 CD Goulon fileté
 CD Threaded studs
 CD Sworznie typu



6-10mm cd stud
 - [Back/Zurück/tilbage](#)

CD STUDS M3 - M5				
	St 37	Almg	Rustfri	Messing
Størrelse	art nr	art nr	art nr	art nr
M3x 6	1103006	1403006	1203006	1303006
M3x 8	1103008	1403008	1203008	1303008
M3x10	1103010	1403010	1203010	1103010
M3x12	1103012	1403012	1203012	1303012
M3x16	1103016	1403016	1203016	1303016
M3x20	1103020	1403020	1203020	1303020
M3x25	1103025	1403025	1203025	1303025
M3x30	1103030	1403030	1203030	1303030
M3x35	1105035	1403035	1203035	1303035
M4x 6	1104006	1404006	1204006	1304006
M4x 8	1104008	1404008	1204008	1304008
M4x10	1104010	1404010	1204010	1304010
M4x12	1104012	1404012	1204012	1304012
M4x16	1104016	1404016	1204016	1304016
M4x20	1104020	1404020	1204020	1304020
M4x25	1104025	1404025	1204025	1304025
M4x30	1104030	1404030	1204030	1304030
M4x35	1104035	1404035	1204035	1304035
M4x40	1104040	1404040	1204040	1304040
M4x45	1104045	1404045	1204045	1304045
M4x50	1104050	1404050	1204050	1304050
M4x55	1104055	1404055	1204055	1304055
M5x 6	1105006	1405006	1205006	1305006
M5x 8	1105008	1405008	1205008	1305008
M5x10	1105010	1405010	1205010	1405010
M5x12	1105012	1405012	1205012	1305012
M5x16	1105016	1405016	1205016	1305016
M5x20	1105020	1405020	1205020	1305020
M5x25	1105025	1405025	1205025	1305025
M5x30	1105030	1405030	1205030	1305030
M5x35	1105035	1405035	1205035	1305035
M5x40	1105040	1405040	1205040	1305040
M5x45	1105045	1405045	1205045	1305045
M5x50	1105050	1405050	1205050	1305050
M5x55	1105055	1405055	1205055	1305055
M5x60	1105060	1405060	1205060	1305060

M	d ₁	d ₃	h	length
M3	3	4,5	0,7	6-35
M4	4	5,5	0,7	8-55
M5	5	6,5	0,8	8-60

d₁ + 0,1mm ; h + 0,2mm
 L indtil 10mm + 0,3mm
 L indtil 20mm + 0,4mm
 L over 20mm + 0,6mm

All dimensions in mm.

BOLTEHOLDER DABOTEK SOYER BHS	
M3	8250003
M4	8250004
M5	8250005
M6	8250006
M7,1	8250071
M8	8250008
M10	8250010

DABOTEK STUD SPECIFICATION

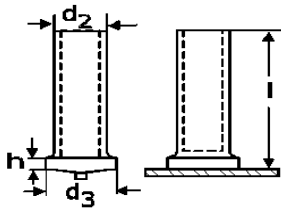

CD Gewindebolzen
 CD Goulon fileté
 CD Threaded studs
 CD Sworznie typu



3-5mm cd stud
 - Back.Zurück.tilbage

CD STUDS M6 - M10				
	St 37	Almg	Rustfri	Messing
Størrelse	art nr	art nr	art nr	art nr
M6x 6	1106006	1406006	1206006	1306006
M6x 8	1106008	1406008	1206008	1306008
M6x10	1106010	1406010	1206010	1106010
M6x12	1106012	1406012	1206012	1306012
M6x16	1106016	1406016	1206016	1306016
M6x20	1106020	1406020	1206020	1306020
M6x25	1106025	1406025	1206025	1306025
M6x30	1106030	1406030	1206030	1306030
M6x35	1106035	1406035	1206035	1306035
M8x10	1108010	1408010	1208010	1308010
M8x12	1108012	1408012	1208012	1308012
M8x16	1108016	1408016	1208016	1308016
M8x20	1108020	1408020	1208020	1308020
M8x25	1108025	1408025	1208025	1308025
M8x30	1108030	1408030	1208030	1308030
M8x35	1108035	1408035	1208035	1308035
M8x40	1108040	1408040	1208040	1308040
M8x45	1108045	1408045	1208045	1308045
M8x50	1108050	1408050	1208050	1308050
M8x55	1108055	1408055	1208055	1308055
M8x60	1108060	1408060	1208060	1308060
M8x65	1108065	1408065	1208065	1308065
M4x70	1108070	1408070	1208070	1308070
M8x75	1108075	1408075	1208075	1308075
M10x10	1110010	1410010	1210010	1310010
M10x12	1110012	1410012	1210012	1310012
M10x16	1110016	1410016	1210016	1310016
M10x20	1110020	1410020	1210020	1310020
M10x25	1110025	1410025	1210025	1310025
M10x30	1110030	1410030	1210030	1310030
M10x35	1110035	1410035	1210035	1310035
M10x40	1110040	1410040	1210040	1310040
M10x45	1110045	1410045	1210045	1310045
M10x50	1110050	1410050	1210050	1310050
M10x55	1110055	1410055	1210055	1310055
M10x60	1110060	1410060	1210060	1310060

M	d_1	d_3	h	length
M6	6	7,5	1,0	6-35
M8	8	9,0	1,0	10-75
M10	10	11,5	1,2	8-60

$d_1 + 0,1\text{mm}$; $h + 0,2\text{mm}$
 L indtil 10mm + 0,3mm
 L indtil 20mm + 0,4mm
 L over 20mm + 0,6mm

All dimensions in mm.

BOLTEHOLDER	
DABOTEK	
SOYER	
HBS	
M3	8250003
M4	8250004
M5	8250005
M6	8250006
M7,1	8250071
M8	8250008
M10	8250010

DABOTEK STUD SPECIFICATION

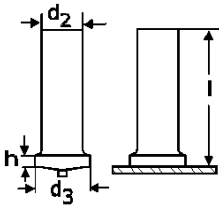

CD Stift
CD Goulon lisse
CD No-Threaded Stud
CD Sztyft typu



[CD STIFTER 6mm stud](#)
[- Back,Zurück,tilbage](#)

CD STIFT 3 - 5 mm				
	St 37	Almg	Rustfri	Messing
Størrelse	art nr	art nr	art nr	art nr
Ø3x 6	2103006	2403006	2203006	2303006
Ø3x 8	2103008	2403008	2203008	2303008
Ø3x10	2103010	2403010	2203010	2303010
Ø3x12	2103012	2403012	2203012	2303012
Ø3x16	2103016	2403016	2203016	2303016
Ø3x20	2103020	2403020	2203020	2303020
Ø3x25	2103025	2403025	2203025	2303025
Ø3x30	2103030	2403030	2203030	2303030
Ø3x35	2105035	2403035	2203035	2303035
Ø4x 6	2104006	2404006	2204006	2304006
Ø4x 8	2104008	2404008	2204008	2304008
Ø4x10	2104010	2404010	2204010	2304010
Ø4x12	2104012	2404012	2204012	2304012
Ø4x16	2104016	2404016	2204016	2304016
Ø4x20	2104020	2404020	2204020	2304020
Ø4x25	2104025	2404025	2204025	2304025
Ø4x30	2104030	2404030	2204030	2304030
Ø4x35	2104035	2404035	2204035	2304035
Ø4x40	2104040	2404040	2204040	2304040
Ø4x45	2104045	2404045	2204045	2304045
Ø4x50	2104050	2404050	2204050	2304050
Ø4x55	2104055	2404055	2204055	2304055
Ø5x 6	2105006	2405006	2205006	2305006
Ø5x 8	2105008	2405008	2205008	2305008
Ø5x10	2105010	2405010	2205010	2305010
Ø5x12	2105012	2405012	2205012	2305012
Ø5x16	2105016	2405016	2205016	2305016
Ø5x20	2105020	2405020	2205020	2305020
Ø5x25	2105025	2405025	2205025	2305025
Ø5x30	2105030	2405030	2205030	2305030
Ø5x35	2105035	2405035	2205035	2305035
Ø5x40	2105040	2405040	2205040	2305040
Ø5x45	2105045	2405045	2205045	2305045
Ø5x50	2105050	2405050	2205050	2305050
Ø5x55	2105055	2405055	2205055	2305055
Ø5x60	2105060	2405060	2205060	2305060

Ø	d ₂	d ₃	h	length
	3	4,5	0,7	6-35
	4	5,5	0,8	8-55
	5	6,5	1	8-60

d1 + 0,1mm ; h + 0,2mm
 L indtil 10mm + 0,3mm
 L indtil 20mm + 0,4mm
 L over 20mm + 0,6mm

All dimensions in mm.

BOLTEHOLDER	
DABOTEK	
SOYER	
HBS	
M3	8250003
M4	8250004
M5	8250005
M6	8250006
M7,1	8250071
M8	8250008
M10	8250010

DABOTEK STUD SPECIFICATION

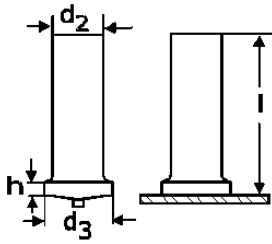

CD Stift
CD Goulon lisse
CD No-Threaded Stud
CD Szyft typu



[CD STIFTER 3-5mm stud](#)
[- Back,Zurück,tilbage](#)

CD STIFT 6 MM				
	St 37	Almg	Rustfri	Messing
Størrelse	art nr	art nr	art nr	art nr
Ø6x 6	2106006	2406006	1206006	2306006
Ø6x 8	2106008	2406008	1206008	2306008
Ø6x10	2106010	2406010	1206010	2306010
Ø6x12	2106012	2406012	1206012	2306012
Ø6x16	2106016	2406016	1206016	2306016
Ø6x20	2106020	2406020	1206020	2306020
Ø6x25	2106025	2406025	1206025	2306025
Ø6x30	2106030	2406030	1206030	2306030
Ø6x35	2106035	2406035	1206035	2306035
Ø7,1x10	2171010	2471010	2207010	2371010
Ø7,1x12	2171012	2471012	2271012	2371012
Ø7,1x16	2171016	2471016	2271016	2371016
Ø7,1x20	2171020	2471020	2271020	2371020
Ø7,1x25	2171025	2471025	2271025	2371025
Ø7,1x30	2171030	2471030	2271030	2371030
Ø7,1x35	2171035	2471035	2271035	2371035

M	d ₂	d ₃	h	length
Ø3	3	4,5	0,7	6-35
Ø4	4	5,5	0,7	8-55
Ø5	5	6,5	0,8	8-55
Ø6	6	7,5	1	8-55
Ø7,1	7,1	8,5	1	8-55

d1 + 0,1mm ; h + 0,2mm
 L indtil 10mm + 0,3mm
 L indtil 20mm + 0,4mm
 L over 20mm + 0,6mm

All dimensions in mm.

BOLTEHOLDER <i>DABOTEK</i> <i>SOYER</i> <i>HBS</i>	
M3	8250003
M4	8250004
M5	8250005
M6	8250006
M7,1	8250071
M8	8250008
M10	8250010

DABOTEK STUD SPECIFICATION

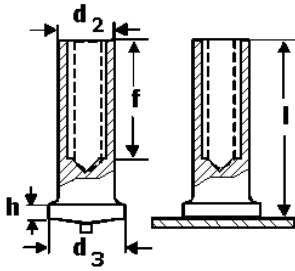

CD Innengewindebüchse
CD Douille taraudée
CD Tapped Stud
CD Gwintowana tulejka

[- Back,Zurück,tilbage](#)



CD bushes			
Dimension	St 37-3K	Almg3	Rustfri
	art nr	art nr	art nr
M3 5x 6	3135006	3435006	3235006
M3 5x 8	3135008	3435008	3235008
M3 5x10	3135010	3435010	3235010
M3 5x12	3135012	3435012	3235012
M3 5x16	3135016	3435016	3235016
M3 5x20	3135020	3435020	3235020
M3 5x25	3135025	3435025	3235025
M3 5x30	3135030	3435030	3235030
M4 4x 8	3146008	3446008	3246008
M4 6x10	3146010	3446010	3246010
M4 6x12	3146012	3446012	3246012
M4 6x15	3146015	3446015	3246015
M4 6x16	3146016	3446016	3246016
M4 6x20	3146020	3446020	3246020
M4 6x25	3146025	3446025	3246025
M4 6x30	3146030	3446030	3246030
M5 8x10	3157010	3457010	3257010
M5 8x12	3157012	3457012	3257012
M5 8x16	3157016	3457016	3257016
M5 8x20	3157020	3457020	3257020
M5 8x25	3157025	3457025	3257025
M5 8x30	3157030	3457030	3257035
M5 8x35	3157035	3457035	3257040
M5 8x40	3157040	3457040	3257040

M	d ₂	d ₃	h	f	length
3	5	6,5	0,8	5	8-35
4	6	7,5	1	6	8-35
5	7,1	8,5	1	7	8-35

d₂ + 0,1mm ; h + 0,2mm
 L indtil 10mm + 0,3mm
 L indtil 20mm + 0,4mm
 L over 20mm + 0,6mm

All dimensions in mm.

BOLTEHOLDER	
<i>DABOTEK</i>	
<i>SOYER</i>	
<i>HBS</i>	
M3	8250003
M4	8250004
M5	8250005
M6	8250006
M7,1	8250071
M8	8250008
M10	8250010

page 5

This page was created by [DABOTEK](#) on 20. March 1997.

DABOTEK STUD SPECIFICATION

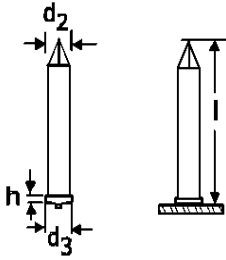

CD Isolierstift
CD Clou d'isolation
CD Insulation Pin
CD Sworznie izolacyjne



[- Back.Zurück.tilbage](#)

CD ISO Pin				M	d ₁	d ₃	h	length																						
Dimension	St 37-3K	Almg3	Rustfri	2,1	2,1	3,6	0,6	15-100																						
	art nr	art nr	art nr	2,6	2,6	4,5	0,7	15-150																						
3x 15	4066405	4070402	4068408	3	3	5,0	0,7	15-150																						
3x 20	4066413	4070410	4068416	d1 + 0,1mm ; h + 0,2mm																										
3x 25	4066421	4070429	4068424	L indtil 10mm + 0,3mm																										
3x 30	4066448	4070429	4068432	L indtil 20mm + 0,4mm																										
3x 40	4044456	4070437	4068440	L over 20mm + 0,6mm																										
3x 50	4066464	4070455	4068459	All dimensions in mm.																										
3x 60	4066472	4070453	4068467	<table border="1"> <thead> <tr> <th colspan="2">BOLTEHOLDER</th> </tr> <tr> <th colspan="2">DABOTEK</th> </tr> <tr> <th colspan="2">SOYER</th> </tr> <tr> <th colspan="2">HBS</th> </tr> </thead> <tbody> <tr> <td>M3</td> <td>8250003</td> </tr> <tr> <td>M4</td> <td>8250004</td> </tr> <tr> <td>M5</td> <td>8250005</td> </tr> <tr> <td>M6</td> <td>8250006</td> </tr> <tr> <td>M7,1</td> <td>8250071</td> </tr> <tr> <td>M8</td> <td>8250008</td> </tr> <tr> <td>M10</td> <td>8250010</td> </tr> </tbody> </table>					BOLTEHOLDER		DABOTEK		SOYER		HBS		M3	8250003	M4	8250004	M5	8250005	M6	8250006	M7,1	8250071	M8	8250008	M10	8250010
BOLTEHOLDER																														
DABOTEK																														
SOYER																														
HBS																														
M3	8250003																													
M4	8250004																													
M5	8250005																													
M6	8250006																													
M7,1	8250071																													
M8	8250008																													
M10	8250010																													
3x 70	4044480	4070461	4068475																											
3x 80	4066499	4070488	4068475																											
3x 90	4066502	4070496	4068483																											
3x100	4066510	4070518	4068513																											

page 6

This page was created by [DABOTEK](#) on 20. March 1997.

DABOTEK STUD SPECIFICATION

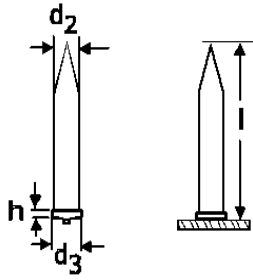

CD Needles
CD Nadeln
CD Aiguilles en maillechort a souder
CD nåle

[-- Back,Zurück,tilbage](#)

Werkstoff-Material-Matière			
Dimension	brass	Nickel Silver	Weight per 1000
	art nr	art nr	art nr
1x10	0101010	0201010	0,07
1x15	0101015	0201015	0,10
1x20	0101020	0201020	0,14
1x25	0101025	0201025	1,18
1x30	0101030	0201030	
1x35	0101035	0201035	1,24
1x40	0101040	0201040	1,27
1x45	0101045	0201045	1,30

M	d1	d3	f	length
1,0	1,0	2,1	0,5	10-45

All dimensions in mm.

Fleuted Needles
Gereiffelt Nadeln
A rainures souder
Rillierede nåle

Werkstoff-Material-Matière			
Dimension	brass	Nickel Silver	Weight per 1000
	art nr	art nr	art nr
1x35	0301035	0401035	1,24
1x40	0301040	0401040	1,27
1*45	0301035	0401035	1,30

Andere Abmessungen auf Anfrage
 Other dimensions on request
 Autres dimensions tells que sur demande

This page was created by [DABOTEK](#) on 26. February 1997.

page 7

DABOTEK CD STUD SPECIFICATION

SPADESTIK

[- Back,Zurück,tilbage](#)

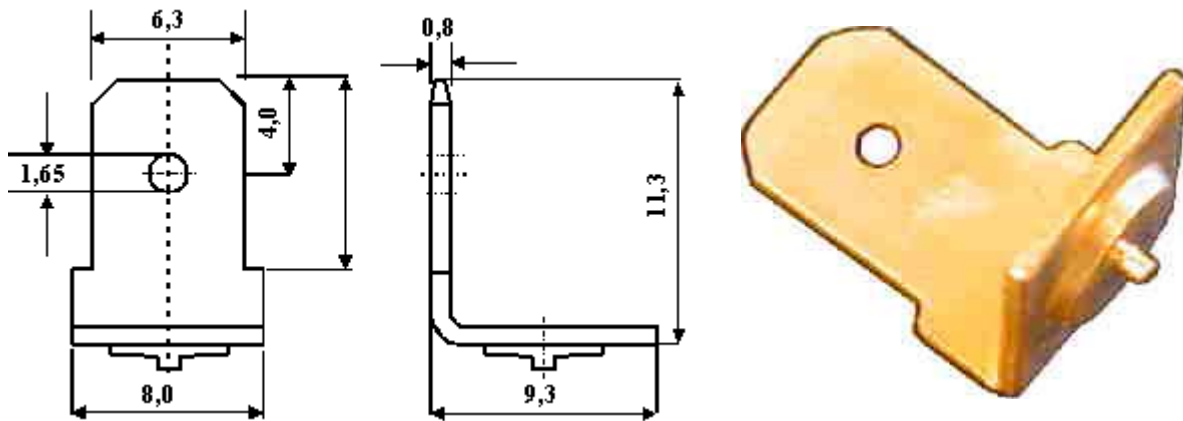

Varenr.	Beskrivelse:	Materiale
4072200	Spadestik	St 37-3
4072014	-----"	Messing
4072030	-----"	Aluminium
4072065	-----"	rustfri

DOBBELT SPADESTIK

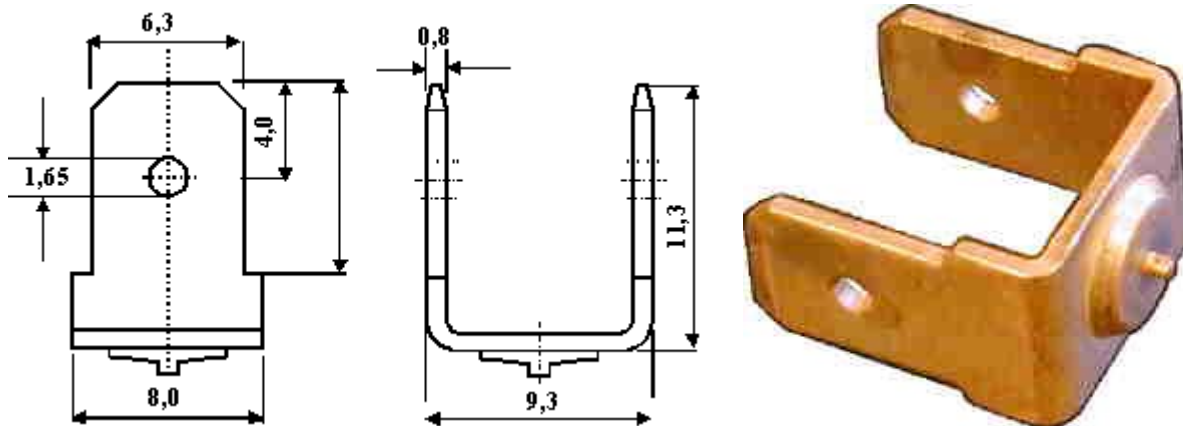

Varenr.	Beskrivelse:	Materiale
4072223	Dobbelt spadestik	St 37-3

STRENGT GRADE DESIGNATION 4.0

page 8

DABOTEK SHORT CYCLE STUD SPECIFICATION

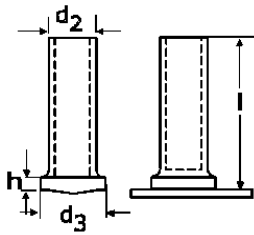

SC Gewindebolzen
SC Goulon fileté
SC Threaded studs
SC Sworznie typu



6-10mm sc stud
- Back.Zurück.tilbage

SHORTCYCLE STUDS M3 - M5					M	d ₁	d ₃	h	length
	St 37	Almg	Rustfri	Messing	M3	3	4,5	0,7	6-35
Størrelse	art nr	art nr	art nr	art nr	M4	4	5,5	0,7	8-55
M3x 6	SC1103006	SC1403006	SC1203006	SC1303006	M5	5	6,5	0,8	8-60
M3x 8	SC1103008	SC1403008	SC1203008	SC1303008	d1 + 0,1mm ; h + 0,2mm L indtil 10mm + 0,3mm L indtil 20mm + 0,4mm L over 20mm + 0,6mm All dimensions in mm.				
M3x10	SC1103010	SC1403010	SC1203010	SC1303010					
M3x12	SC1103012	SC1403012	SC1203012	SC1303012					
M3x16	SC1103016	SC1403016	SC1203016	SC1303016					
M3x20	SC1103020	SC1403020	SC1203020	SC1303020					
M3x25	SC1103025	SC1403025	SC1203025	SC1303025					
M3x30	SC1103030	SC1403030	SC1203030	SC1303030					
M3x35	SC1105035	SC1403035	SC1203035	SC1303035					
M4x 6	SC1104006	SC1404006	SC1204006	SC1304006	BOLTEHOLDER DABOTEK SOYER HBS				
M4x 8	SC1104008	SC1404008	SC1204008	SC1304008					
M4x10	SC1104010	SC1404010	SC1204010	SC1304010					
M4x12	SC1104012	SC1404012	SC1204012	SC1304012					
M4x16	SC1104016	SC1404016	SC1204016	SC1304016					
M4x20	SC1104020	SC1404020	SC1204020	SC1304020					
M4x25	SC1104025	SC1404025	SC1204025	SC1304025					
M4x30	SC1104030	SC1404030	SC1204030	SC1304030					
M4x35	SC1104035	SC1404035	SC1204035	SC1304035					
M4x40	SC1104040	SC1404040	SC1204040	SC1304040					
M4x45	SC1104045	SC1404045	SC1204045	SC1304045					
M4x50	SC1104050	SC1404050	SC1204050	SC1304050					
M4x55	SC1104055	SC1404055	SC1204055	SC1304055					
M5x 6	SC1105006	SC1405006	SC1205006	SC1305006					
M5x 8	SC1105008	SC1405008	SC1205008	SC1305008					
M5x10	SC1105010	SC1405010	SC1205010	SC1305010					
M5x12	SC1105012	SC1405012	SC1205012	SC1305012					
M5x16	SC1105016	SC1405016	SC1205016	SC1305016					
M5x20	SC1105020	SC1405020	SC1205020	SC1305020					
M5x25	SC1105025	SC1405025	SC1205025	SC1305025					
M5x30	SC1105030	SC1405030	SC1205030	SC1305030					
M5x35	SC1105035	SC1405035	SC1205035	SC1305035					
M5x40	SC1105040	SC1405040	SC1205040	SC1305040					
M5x45	SC1105045	SC1405045	SC1205045	SC1305045					
M5x50	SC1105050	SC1405050	SC1205050	SC1305050					
M5x55	SC1105055	SC1405055	SC1205055	SC1305055					
M5x60	SC1105060	SC1405060	SC1205060	SC1305060					

DABOTEK SHORT CYCLE STUD SPECIFICATION

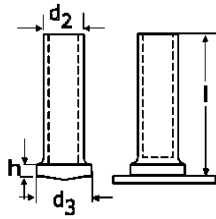

SC Gewindebolzen
SC Goulon fileté
SC Threaded studs
SC Sworznie typu



[3-5mm sc studs](#)
[- Back.Zurück.tilbage](#)

SHORTCYCLE STUDS M6 - M10				
	St 37	Almg	Rustfri	Messing
Størrelse	art nr	art nr	art nr	art nr
M6x 6	SC1106006	SC1406006	SC1206006	SC1306006
M6x 8	SC1106008	SC1406008	SC1206008	SC1306008
M6x10	SC1106010	SC1406010	SC1206010	SC1106010
M6x12	SC1106012	SC1406012	SC1206012	SC1306012
M6x16	SC1106016	SC1406016	SC1206016	SC1306016
M6x20	SC1106020	SC1406020	SC1206020	SC1306020
M6x25	SC1106025	SC1406025	SC1206025	SC1306025
M6x30	SC1106030	SC1406030	SC1206030	SC1306030
M6x35	SC1106035	SC1406035	SC1206035	SC1306035
M8x10	SC1108010	SC1408010	SC1208010	SC1308010
M8x12	SC1108012	SC1408012	SC1208012	SC1308012
M8x16	SC1108016	SC1408016	SC1208016	SC1308016
M8x20	SC1108020	SC1408020	SC1208020	SC1308020
M8x25	SC1108025	SC1408025	SC1208025	SC1308025
M8x30	SC1108030	SC1408030	SC1208030	SC1308030
M8x35	SC1108035	SC1408035	SC1208035	SC1308035
M8x40	SC1108040	SC1408040	SC1208040	SC1308040
M8x45	SC1108045	SC1408045	SC1208045	SC1308045
M8x50	SC1108050	SC1408050	SC1208050	SC1308050
M8x55	SC1108055	SC1408055	SC1208055	SC1308055
M8x60	SC1108060	SC1408060	SC1208060	SC1308060
M8x65	SC1108065	SC1408065	SC1208065	SC1308065
M4x70	SC1108070	SC1408070	SC1208070	SC1308070
M8x75	SC1108075	SC1408075	SC1208075	SC1308075
M10x10	SC1110010	SC1410010	SC1210010	SC1410010
M10x12	SC1110012	SC1410012	SC1210012	SC1310012
M10x16	SC1110016	SC1410016	SC1210016	SC1310016
M10x20	SC1110020	SC1410020	SC1210020	SC1310020
M10x25	SC1110025	SC1410025	SC1210025	SC1310025
M10x30	SC1110030	SC1410030	SC1210030	SC1310030
M10x35	SC1110035	SC1410035	SC1210035	SC1310035
M10x40	SC1110040	SC1410040	SC1210040	SC1310040
M10x45	SC1110045	SC1410045	SC1210045	SC1310045
M10x50	SC1110050	SC1410050	SC1210050	SC1310050
M10x55	SC1110055	SC1410055	SC1210055	SC1310055
M10x60	SC1110060	SC1410060	SC1210060	SC1310060

This page was created by [DABOTEK](#) on 20. March 1997.

M	d ₁	d ₃	h	length
M6	6	7,5	1,0	6-35
M8	8	9,0	1	8-75
M10	10	11,5	1,2	8-45

d1 + 0,1mm ; h + 0,2mm
 L indtil 10mm + 0,3mm
 L indtil 20mm + 0,4mm
 L over 20mm + 0,6mm

All dimensions in mm.

BOLTEHOLDER	
<i>DABOTEK</i>	
<i>SOYER</i>	
<i>HBS</i>	
M3	8250003
M4	8250004
M5	8250005
M6	8250006
M7,1	8250071
M8	8250008
M10	8250010

DABOTEK SHORT CYCLE STUD SPECIFICATION

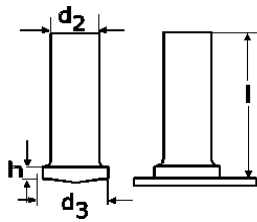

SC Stift
SC Goulon lisse
SC No-Threaded Stud
SC Sztyft typu



[SC STIFTER 6mm stud](#)
[- Back.Zurück.tilbage](#)

SC STIFT 3 - 5 mm				
	St 37	Almg	Rustfri	Messing
Størrelse	art nr	art nr	art nr	art nr
Ø3x 6	SC2103006	SC2403006	SC2203006	SC2303006
Ø3x 8	SC2103008	SC2403008	SC2203008	SC2303008
Ø3x10	SC2103010	SC2403010	SC2203010	SC2103010
Ø3x12	SC2103012	SC2403012	SC2203012	SC2303012
Ø3x16	SC2103016	SC2403016	SC2203016	SC2303016
Ø3x20	SC2103020	SC2403020	SC2203020	SC2303020
Ø3x25	SC2103025	SC2403025	SC2203025	SC2303025
Ø3x30	SC2103030	SC2403030	SC2203030	SC2303030
Ø3x35	SC2105035	SC2403035	SC2203035	SC2303035
Ø4x 6	SC2104006	SC2404006	SC2204006	SC2304006
Ø4x 8	SC2104008	SC2404008	SC2204008	SC2304008
Ø4x10	SC2104010	SC2404010	SC2204010	SC2304010
Ø4x12	SC2104012	SC2404012	SC2204012	SC2304012
Ø4x16	SC2104016	SC2404016	SC2204016	SC2304016
Ø4x20	SC2104020	SC2404020	SC2204020	SC2304020
Ø4x25	SC2104025	SC2404025	SC2204025	SC2304025
Ø4x30	SC2104030	SC2404030	SC2204030	SC2304030
Ø4x35	SC2104035	SC2404035	SC2204035	SC2304035
Ø4x40	SC2104040	SC2404040	SC2204040	SC2304040
Ø4x45	SC2104045	SC2404045	SC2204045	SC2304045
Ø4x50	SC2104050	SC2404050	SC2204050	SC2304050
Ø4x55	SC2104055	SC2404055	SC2204055	SC2304055
Ø5x 6	SC2105006	SC2405006	SC2205006	SC2305006
Ø5x 8	SC2105008	SC2405008	SC2205008	SC2305008
Ø5x10	SC2105010	SC2405010	SC2205010	SC2405010
Ø5x12	SC2105012	SC2405012	SC2205012	SC2305012
Ø5x16	SC2105016	SC2405016	SC2205016	SC2305016
Ø5x20	SC2105020	SC2405020	SC2205020	SC2305020
Ø5x25	SC2105025	SC2405025	SC2205025	SC2305025
Ø5x30	SC2105030	SC2405030	SC2205030	SC2305030
Ø5x35	SC2105035	SC2405035	SC2205035	SC2305035
Ø5x40	SC2105040	SC2405040	SC2205040	SC2305040
Ø5x45	SC2105045	SC2405045	SC2205045	SC2305045
Ø5x50	SC2105050	SC2405050	SC2205050	SC2305050
Ø5x55	SC2105055	SC2405055	SC2205055	SC2305055
Ø5x60	SC2105060	SC2405060	SC2205060	SC2305060

M	d ₁	d ₃	h	length
2,1	2,1	3,4	0,6	8-45
2,6	2,6	4,5	0,7	6-25
3	3	4,5	0,7	6-25
4	4	5,5	0,8	8-40
5	5	6,5	1	8-40
6	6	7,5	1	10-50

d₁ + 0,1mm ; h + 0,2mm
 L indtil 10mm + 0,3mm
 L indtil 20mm + 0,4mm
 L over 20mm + 0,6mm

All dimensions in mm.

BOLTEHOLDER DABOTEK SOYER HBS	
M3	8250003
M4	8250004
M5	8250005
M6	8250006
M7,1	8250071
M8	8250008
M10	8250010

DABOTEK SHORT CYCLE STUD SPECIFICATION

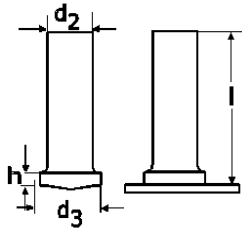

SC Stift
SC Goulon lisse
SC No-Threaded Stud
SC Sztyft typu



[SC STIFTER 3-5mm stud](#)
[- Back,Zurück,tilbage](#)

SH STIFT 6 MM				
	St 37	Almg	Rustfri	Messing
Størrelse	art nr	art nr	art nr	art nr
Ø6x6	SC2106006	SC2406006	SC2206006	SC2306006
Ø6x8	SC2106008	SC2406008	SC2206008	SC2306008
Ø6x10	SC2106010	SC2406010	SC2206010	SC2106010
Ø6x12	SC2106012	SC2406012	SC2206012	SC2306012
Ø6x16	SC2106016	SC2406016	SC2206016	SC2306016
Ø6x20	SC2106020	SC2406020	SC2206020	SC2306020
Ø6x25	SC2106025	SC2406025	SC2206025	SC2306025
Ø6x30	SC2106030	SC2406030	SC2206030	SC2306030
Ø6x35	SC2106035	SC2406035	SC2206035	SC2306035

M	d ₁	d ₃	h	length
2,1	2,1	3,4	0,6	8-45
2,6	2,6	4,5	0,7	6-25
3	3	4,5	0,7	6-25
4	4	5,5	0,8	8-40
5	5	6,5	1	8-40
6	6	7,5	1	10-50

d₁ + 0,1mm ; h + 0,2mm
 L indtil 10mm + 0,3mm
 L indtil 20mm + 0,4mm
 L over 20mm + 0,6mm

All dimensions in mm.

BOLTEHOLDER DABOTEK SOYER HBS	
M3	8250003
M4	8250004
M5	8250005
M6	8250006
M7,1	8250071
M8	8250008
M10	8250010

page 12

DABOTEK SHORT CYCLE STUD SPECIFICATION

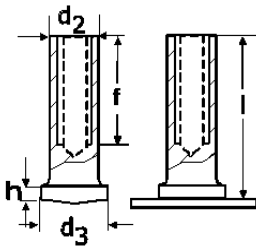

SC
Innengewindebüchse
SC Douille taraudée
SC Tapped Stud
SC Gwintowana tulejka



[- Back,Zurück,tilbage](#)

SH bushes			
Dimension	St 37-3K	Almg3	Rustfri
	art nr	art nr	art nr
M3 5x 6	SC3135006	SC3435006	SC3235006
M3 5x 8	SC3135008	SC3435008	SC3235008
M3 5x10	SC3135010	SC3435010	SC3235010
M3 5x12	SC3135012	SC3435012	SC3235012
M3 5x16	SC3135016	SC3435016	SC3235016
M3 5x20	SC3135020	SC3435020	SC3235020
M3 5x25	SC3135025	SC3435025	SC3235025
M3 5x30	SC3135030	SC3435030	SC3235030
M4 4x 8	SC3146008	SC3446008	SC3246008
M4 6x10	SC3146010	SC3446010	SC3246010
M4 6x12	SC3146012	SC3446012	SC3246012
M4 6x16	SC3146016	SC3446016	SC3246016
M4 6x20	SC3146020	SC3446020	SC3246020
M4 6x25	SC3146025	SC3446025	SC3246025
M4 6x30	SC3146030	SC3446030	SC3246030
M5 8x10	SC3157010	SC3457010	SC3257010
M5 8x12	SC3157012	SC3457012	SC3257012
M5 8x16	SC3157016	SC3457016	SC3257016
M5 8x20	SC3157020	SC3457020	SC3257020
M5 8x25	SC3157025	SC3457025	SC3257025
M5 8x30	SC3157030	SC3457030	SC3257030
M5 8x35	SC3157035	SC3457035	SC3257035
M5 8x40	SC3157040	SC3457040	SC3257040

M	d ₂	d ₃	h	f	length
3	5	6,5	0,8	5	8-35
4	6	7,5	1	6	8-35
5	7,1	8,5	1	7	8-35

d₂ + 0,1mm ; h + 0,2mm
 L indtil 10mm + 0,3mm
 L indtil 20mm + 0,4mm
 L over 20mm + 0,6mm

All dimensions in mm.

BOLTEHOLDER DABOTEK SOYER HBS	
M3	8250003
M4	8250004
M5	8250005
M6	8250006
M7,1	8250071
M8	8250008
M10	8250010

DABOTEK SHORT CYCLE STUDS

FULL FLANGED THREADED SC STUDS

[- Back,Zurück,tilbage](#)

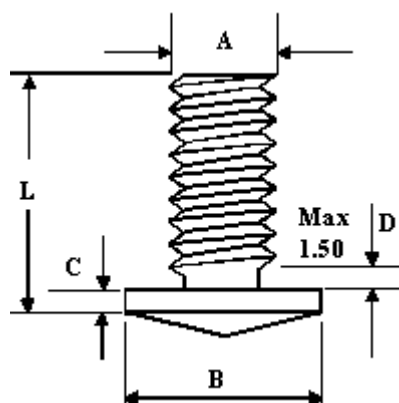

"A"	"B"	"C"	"D"	"L"	CODE
M2.5	3.00 / 4.00	MAX 1.50	MAX 1.50	5.00mm	299
M3	3.50 / 4.50			TO	
M3.5	4.00 / 5.00			50.00mm	
M4	4.50 / 5.50			AS	
M5	5.50 / 6.50			STANDARD	
M6	6.50 / 7.50			SPECIALS	
M8	8.50 / 9.50			UPTO 100.00mm	

* Mild & stainless steel only

MATERIAL	LOV CARBON HIGH QUALITY MILD STEEL	COPPER PLATE
	STAINLESS STEEL SS304	BRIGHT
	ALUMINIUM ALLOY	BRIGHT
	BRASS LEAD FREE	BRIGHT

All dimensions in mm.

page 14

DABOTEK CD STUD SPECIFICATION

DABOTEK CD XMAS TREE STUDS

[- Back,Zurück,tilbage](#)

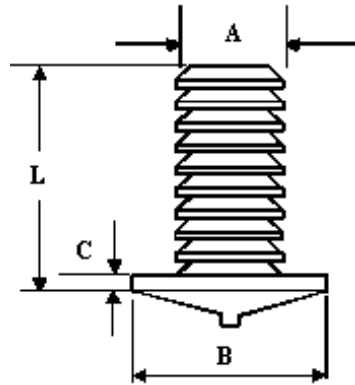

"A"	"B"	"C"	"L"	CODE
4.0	5.00 / 5.80	MS & SS 0,90 MAX	5.00mm TO	201
5.0	6.50 / 7.30		50.00mm	
6.0	7.50 / 8.30	ALUMINIUM 1.50 MAX		

MATERIAL	LOW CARBON HIGH QUALITY MILD STEEL	COPPER PLATE
	STAINLESS STEEL SS304	BRIGHT
	ALUMINIUM ALLOY	BRIGHT
	BRASS LEAD FREE	BRIGHT

All dimensions in mm.

page 15

DABOTEK CD STUD SPECIFICATION

CD TAPPED STUDS

[- Back,Zurück,tilbage](#)

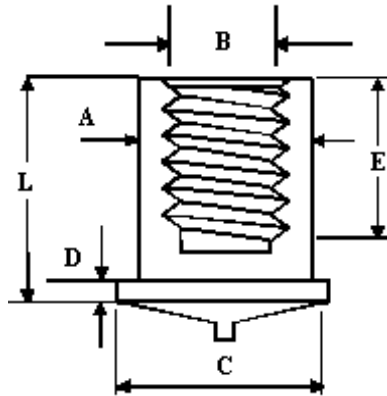

"A"	"B"	"C"	"D"	"L"	"E"	CODE
5.00	M3	6.00	1.00	5.00	12.00	221
6.00	M3/M4	8.00		MIN	STANDARD	
8.00	M3/M4/M5/M6	10.00		
10.00	M4/M5/M6/M8	12.00		50.00	25.00	
12.00	M5/M6/M8/M10	12.70		MAX	SPECIAL	

MATERIAL	LOW CARBON HIGH QUUALITY MILD STEEL	Copper plate
	STAINLESS STEEL SS304	bright
	ALUMINIUM ALLOY	bright
	BRASS LEAD FREE	bright

All dimensions in mm.

page 16

DABOTEK CD STUD SPECIFICATION

CD TAPPED STUDS - NO FLANGE

[- Back,Zurück,tilbage](#)

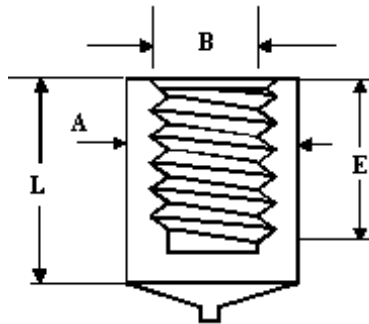

"A"	"B"	"L"	"D"	CODE
5.00	M3			
6.00	M3/M4	5.00	12.00	
8.00	M3/M4/M5/M6	MIN	STANDARD	
10.00	M4/M5/M6/M8	221
12.00	M5/M6/M8/M10	50.00	25.00	
		MAX	SPECIAL	

MATERIAL	LOW CARBON HIGH QUUALITY MILD STEEL	Copper plate
	STAINLESS STEEL SS304	bright
	ALUMINIUM ALLOY	bright
	BRASS LEAD FREE	bright

All dimensions in mm.

page 17

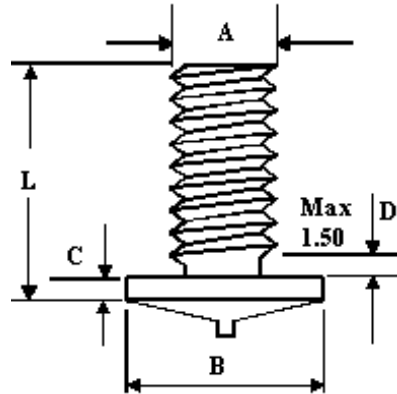
DABOTEK UNC FULL FLANGED THREADED CD STUDS[- Back,Zurück,tilbage](#)

"A"	"B"	"C"	"D"	"L"	CODE
4-40 UNC	4.62 / 4,87	MS & SS		5.00mm	
6-32 UNC	5.41 / 5.66			TO	
8-32 UNC	6.22 / 6.47	0.90	1.50	50.00mm	2001
10-24 UNC	6.22 / 6.47	MAX		AS	2002
1/4 UNC	7.79 / 8.05	BRASS	MAX	STANDARD	2003
5/16 UNC	9.30 / 9.70	& ALUM			
3/8 UNC *	12.00 / 12.50	11.50			2004
		MAX			
		1.00 MAX			

* Mild & stainless steel only

MATERIAL	LOV CARBON HIGH QUALITY MILD STEEL	COPPER PLATE
	STAINLESS STEEL SS304	BRIGHT
	ALUMINIUM ALLOY	BRIGHT
	BRASS LEAD FREE	BRIGHT

All dimensions in mm.

page 18

DABOTEK UNF FULL FLANGED THREADED CD STUDS

[- Back,Zurück,tilbage](#)

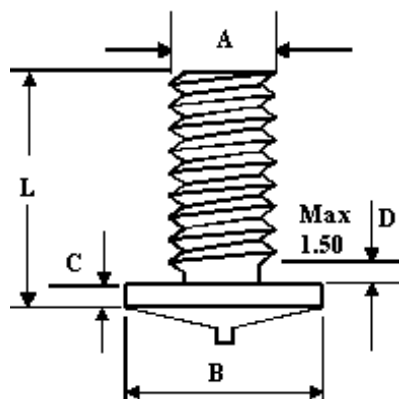

"A"	"B"	"C"	"D"	"L"	CODE
4-48 UNF	4.62 / 4,87	MS & SS	1.50	5.00mm	2011
6-40 UNF	5.41 / 5.66			0.90	
8-36 UNF	6.22 / 6.47	MAX	1.50	AS	2012
10-32 UNF	6.22 / 6.47	BRASS	MAX	STANDARD	2013
1/4 UN	7.79 / 8.05	& ALUM			2014
5/16 UNF	9.30 / 9.70	1.50			
3/8 UNF *	12.00 / 12.50	MAX			

* Mild & stainless steel only

MATERIAL	LOV CARBON HIGH QUALITY MILD STEEL	COPPER PLATE
	STAINLESS STEEL SS304	BRIGHT
	ALUMINIUM ALLOY	BRIGHT
	BRASS LEAD FREE	BRIGHT

All dimensions in mm.

page 19

DABOTEK CD STUD SPECIFICATION

CD aluminium bøs rustfri stål isostift.

[- Back,Zurück,tilbage](#)

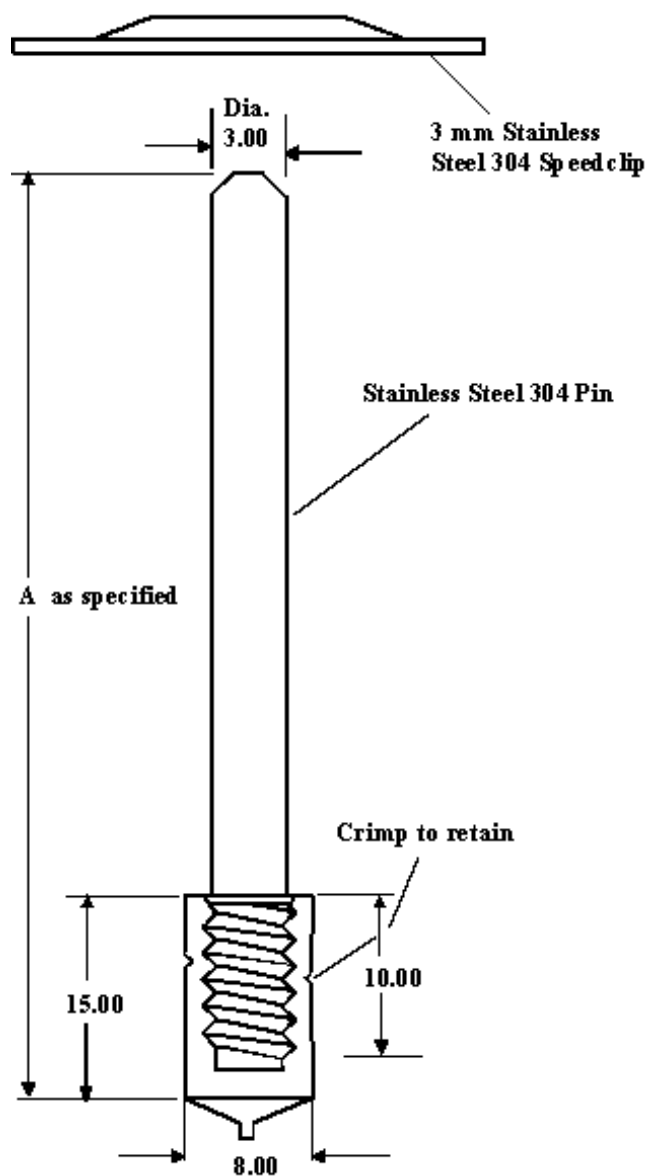

Art nr	Part nr	Bestell nr	Mat.
241-03-040			Almg/st
241-03-050			Almg/st
241-03-060			Almg/st
241-03-070			Almg/st
241-03-085			Almg/st
241-03-100			Almg/st
241-03-115			Almg/st
242-03-040			Almg/ss
242-03-050			Almg/ss
242-03-060			Almg/ss
242-03-070			Almg/ss
242-03-085			Almg/ss
242-03-100			Almg/ss
242-03-115			Almg/ss

DABOTEK CD STUD SPECIFICATION

CD COLLAR STUDS ; KRAVE BOLTE

[- Back,Zurück,tilbage](#)

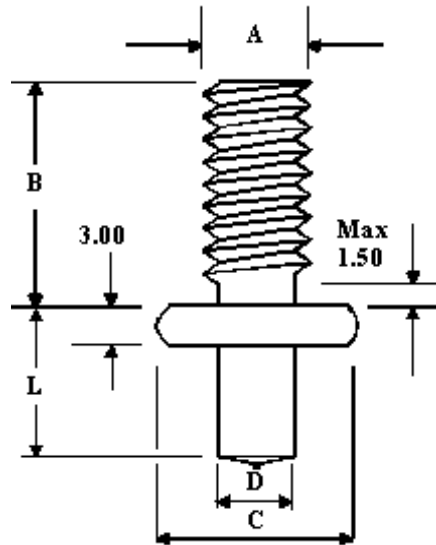

"A"	"B"	"C"	"D"	"L"	CODE
M6	12.00	12.00	5.20	6.00	624
M8	MIN	14.00	7.05	MIN	
M10	MAX	16.00	8.88	MAX	

MATERIAL	LOW CARBON HIGH QUALITY MILD STEEL	COPPER PLATE
	STAINLESS STEEL SS304	BRIGHT
	ALUMINIUM ALLOY	BRIGHT
	BRASS LEAD FREE	BRIGHT

All dimensions in mm.

page 21

DABOTEK CD STUD SPECIFICATION

DABOTEK CD SHOULDER STUDS

CD SKULDER BOLT

[- Back,Zurück,tilbage](#)

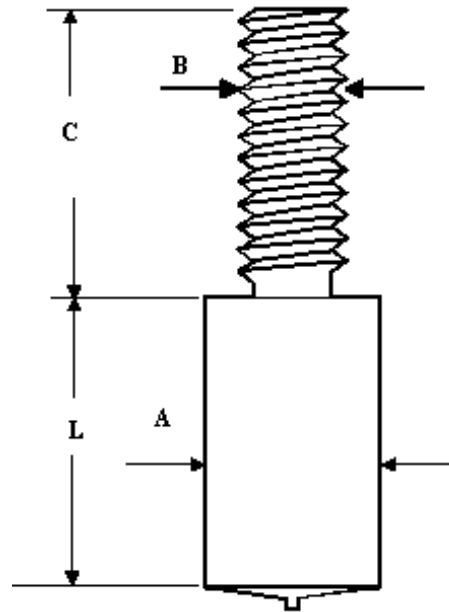

"A"	"B"	"C"	"L"	CODE
4.00	M2.5/M3	50.00	75.00	243
5.00	M3/M4			
6.00	M3/M4/M5			
8.00	M4/M5/M6			
10.00	M4/M5/M6/M8			
12.00	M5/M6/M8/M10	MAX	MAX	

MATERIAL	LOW CARBON HIGH QUALITY MILD STEEL	COPPER PLATE
	STAINLESS STEEL SS304	BRIGHT
	ALUMINIUM ALLOY	BRIGHT
	BRASS LEAD FREE	BRIGHT

All dimensions in mm.

page 22

DABOTEK CD STUD SPECIFICATION

PUNKTSVEJSEBOLTE BW WELD BOLTS

[- Back,Zurück,tilbage](#)

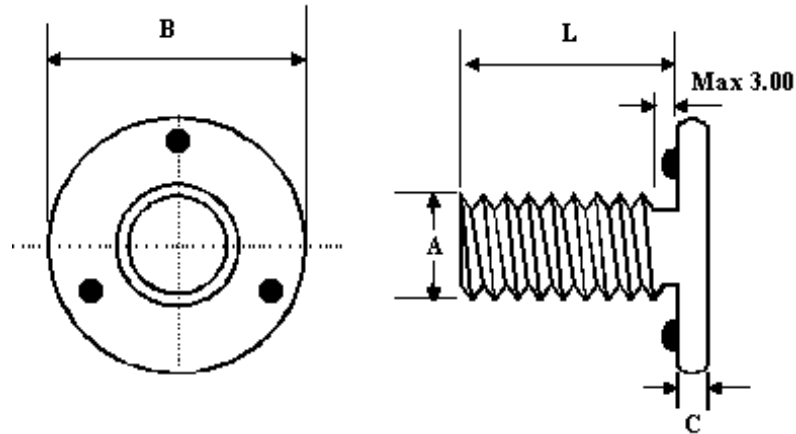

"A"	"B"	"C"	"L"	CODE
M3	5.60 / 6.50	1.10 / 1.50	5.00mm	402
M4	7.60 / 8.40	1.35 / 1.65	to	
M5	9.60 / 10.40	1.75 / 2.16	50.00mm	
M6	11.45 / 12.55	1.90 / 2.64	as	
M8	15.45 / 16.55	2.40 / 3.15	standard	
M10	19.35 / 20.65	2.55 / 4.15	Up to	
M12	23.50 / 25.50	3.50 / 4.50	100.00mm	
			as	
			special	

MATERIAL	LOW CARBON HIGH QUALITY MILD STEEL	natural bright
	STAINLESS STEEL SS304	

All dimensions in mm.

DABOTEK CD STUD SPECIFICATION

PUNKTSVEJSEBOLTE BW WELD BOLTS

[- Back,Zurück,tilbage](#)

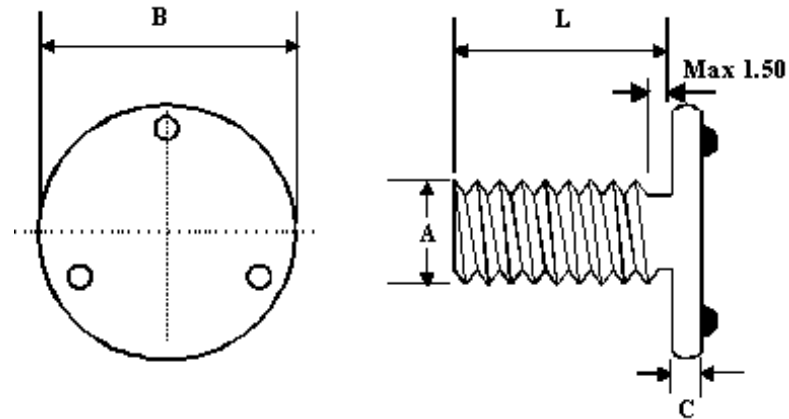

"A"	"B"	"C"	"L"	CODE
M3	5.60 / 6.50	1.10 / 1.50	5.00mm	403
M4	7.60 / 8.40	1.35 / 1.65	to 50.00mm	
M5	9.60 / 10.40	1.75 / 2.16	as	
M6	11.45 / 12.55	1.90 / 2.64	standard	
M8	15.45 / 16.55	2.40 / 3.15	Up to	
M10	19.35 / 20.65	2.55 / 4.15	100.00mm	
M12	23.50 / 25.50	3.50 / 4.50	as special	

MATERIAL	LOW CARBON HIGH QUALITY MILD STEEL	natural bright
	STAINLESS STEEL SS304	

All dimensions in mm.

page 24

DABOTEK CD STUD SPECIFICATION

WELD NUTS

[- Back,Zurück,tilbage](#)

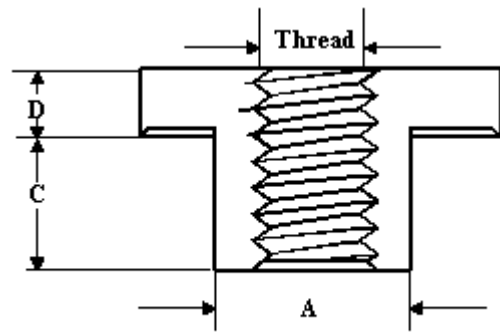

Other thread forms available

Material: Mild steel or
Stainless Steel 304

Finish: Natural

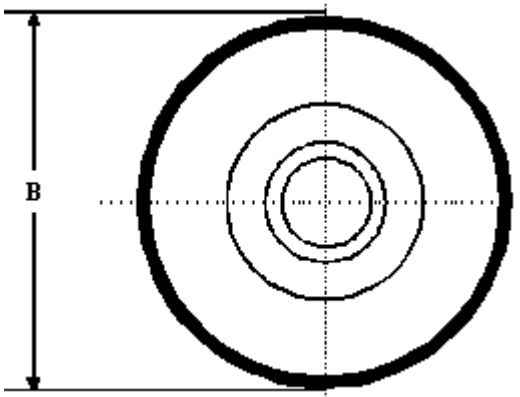

THREAD	"A"	"B"	"C"	"D"	CODE
M3	6.95	10.00	4.00	2.00	630
M4	7.95	10.80	4.20	2.00	
M5	8.95	12.00	4.20	2.00	
M6	9.95	12.70	4.20	2.50	
M8	11.95	12.70	5.00	3.00	
M10	13.95	14.80	5.00	3.00	

STRENGTH GRADE
DESIGNATION 4.0